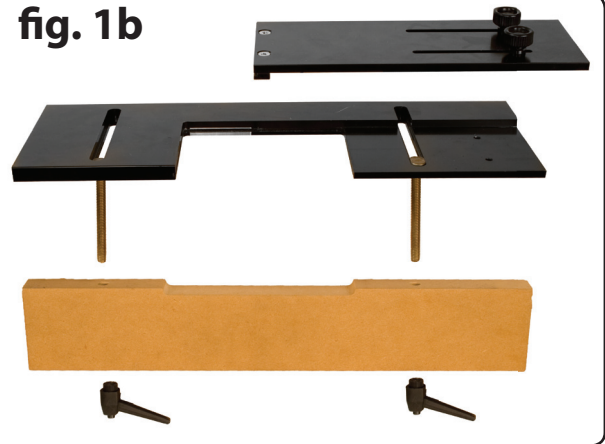

fig. 1a



fig. 1b



The Mortising Jig Includes:

- 1ea. MDF mounting fence
- 1ea. Mortise Jig Platform
- 1ea. Sliding Plate
- 2ea. Studded Knobs
- 2ea. Ratcheting Knobs
- 1ea. Mortising Router Bit

1. First, Assemble the Mortising Jig as shown in **fig. 1b**. The Jig when assembled should resemble the photo shown in **fig. 1a** , and the Sliding Plate should move freely side to side on top of the Mortise Jig Platform.
2. Once Assembled, clamp the Mortising Jig to a solid table top surface as shown in **fig. 2**. The jig can be mounted using c-clamps (not included) either vertically or horizontally. *Note: you may want to clamp the stock you are routing into the jig when mounting.*
3. Now that the jig is mounted, place the hinge you are going to use between the Mortise Jig Platform opening and the sliding plate. Slide the plate over until it touches the hinge (**fig. 3**), and secure the Sliding Plate with the two studded knobs.
4. With the router placed on the jig, set the depth of your router bit to the depth of the hinge you are using.
5. Route the mortise into your stock.
6. Square of the corners (if necessary) with a corner chisel (not included) or a hand chisel (not included)
7. Install your hinge.

fig. 2

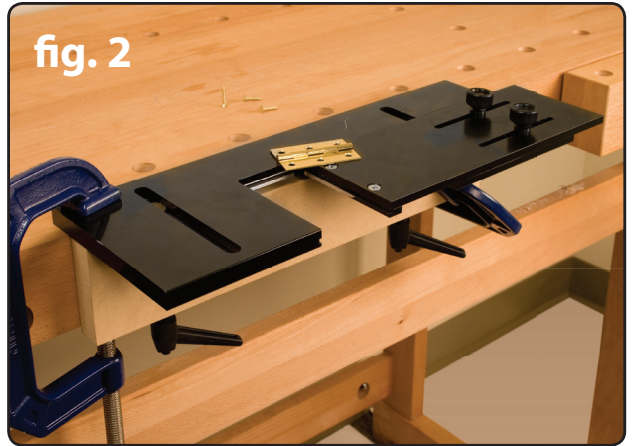

fig. 3

